

HB 78 Stainless Steel Drive Chain

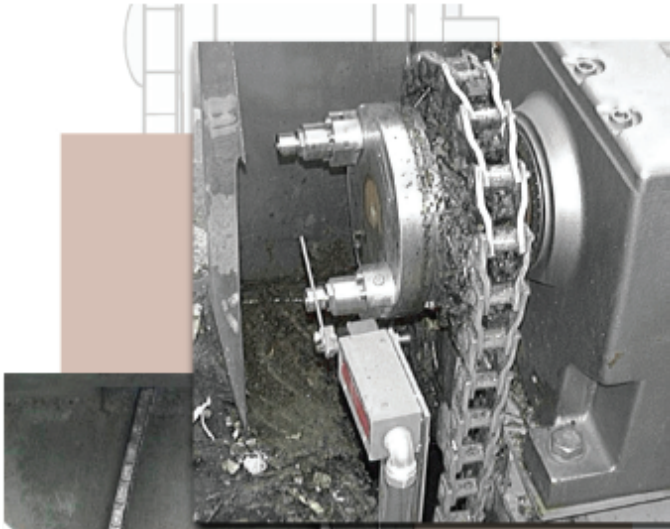

HB78 Stainless Steel Drive chain is the premier pintle chain for harsh and demanding applications. Ideal for water and wastewater requirements. Made of 403 stainless steel, the chain is extremely strong, yet highly corrosion resistant. Consider some of the advantages of HB78 chain:

- Directly interchangeable with all 78 series chains.
- Runs on Cast, Non-Metallic or Stainless tooth sprockets.
- Minimal elongation = less adjustments.
- J-cotter pin for easy link removal/install.
- Available with food grade oil lubrication.

HB78 Stainless Drive Chain

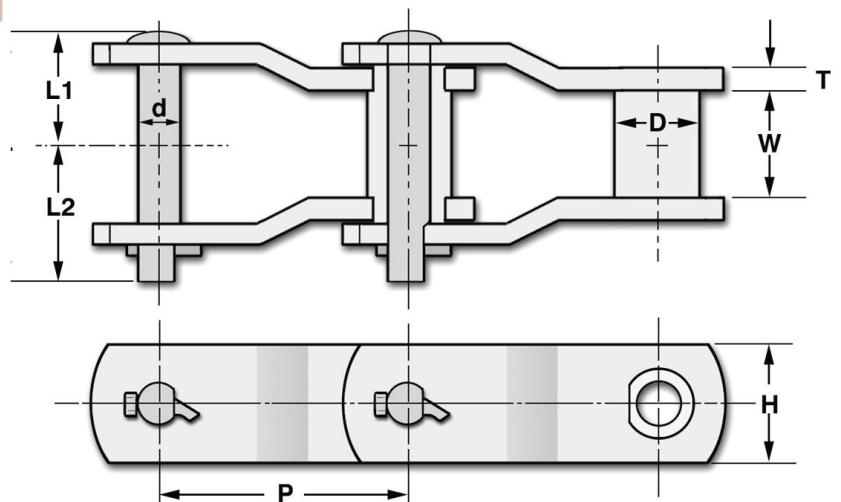

Dimensions and Strength of HB78 Chain

Chain No.	Pitch P (in.)	Working Load (lbs.)	Min. Ultimate Strength (lbs.)	Weight (lbs./ft.)	Barrel		Pin				Side Bar	
					Outside Dia. D (in.)	Width W (in.)	Outside Dia. d (in.)	Length (in.)			Height H (in.)	Thick. T (in.)
								L	L ₁	L ₂		
HB78	2.609	3,300	21,000	3.80	.875	1.125	.4375	2.625	1.1875	1.4375	1.23	.224

NH78 Non-Metallic Drive Chain



NH78 Non-Metallic Chain is a strong, yet light weight alternative to metallic or cast drive chains. Directly interchangeable with 78 series chains and requiring no lubrication, the NH78 chain can be used with cast, plastic or stainless steel sprockets for clarifier drives or drag conveyor applications.

Our NH78 drive chain is made of a glass reinforced nylon material providing additional strength and resistance to elongation. It features a 316SS knurled pin that is easy to install with no cotters or clips. The link material also includes UV inhibitors to resist degradation from sun exposure.

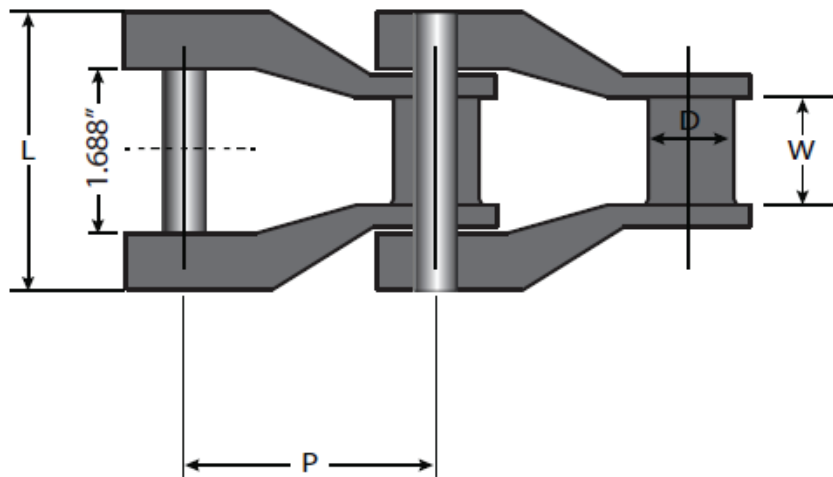

Chain Dimensions Are Given In Inches

Dimensions subject to change

Chain No.	Chain Pitch	Width	Diameter	Height	Pin			Link	Working Load lbs	Average Ultimate Strength lbs	Average Weight lbs/ft
	P	W	D	H	d	L	Material	Material			
NH78	2.609	1.125	0.875	1.125	0.375	2.906	316SS	Glass Reinforced Nylon	1,800	4,000	1.41



SPROCKETS



NON-METALLIC CHAINS



STAINLESS CHAINS



FIBERGLASS FLIGHTS